



RFID JOURNAL VIRTUALLY LIVE!

SEPTEMBER 30 - OCTOBER 1, 2020

With RFID to Transparency

Sebastian Kohl

M.Sc. in Process Engineering

Winterthur- Competence Centre of bogies



SMILE
Trailer bogie



KISS
Trailer bogie



FLIRT X
Jacobs trailer bogie



FLIRT 3
Motor bogie

Sights

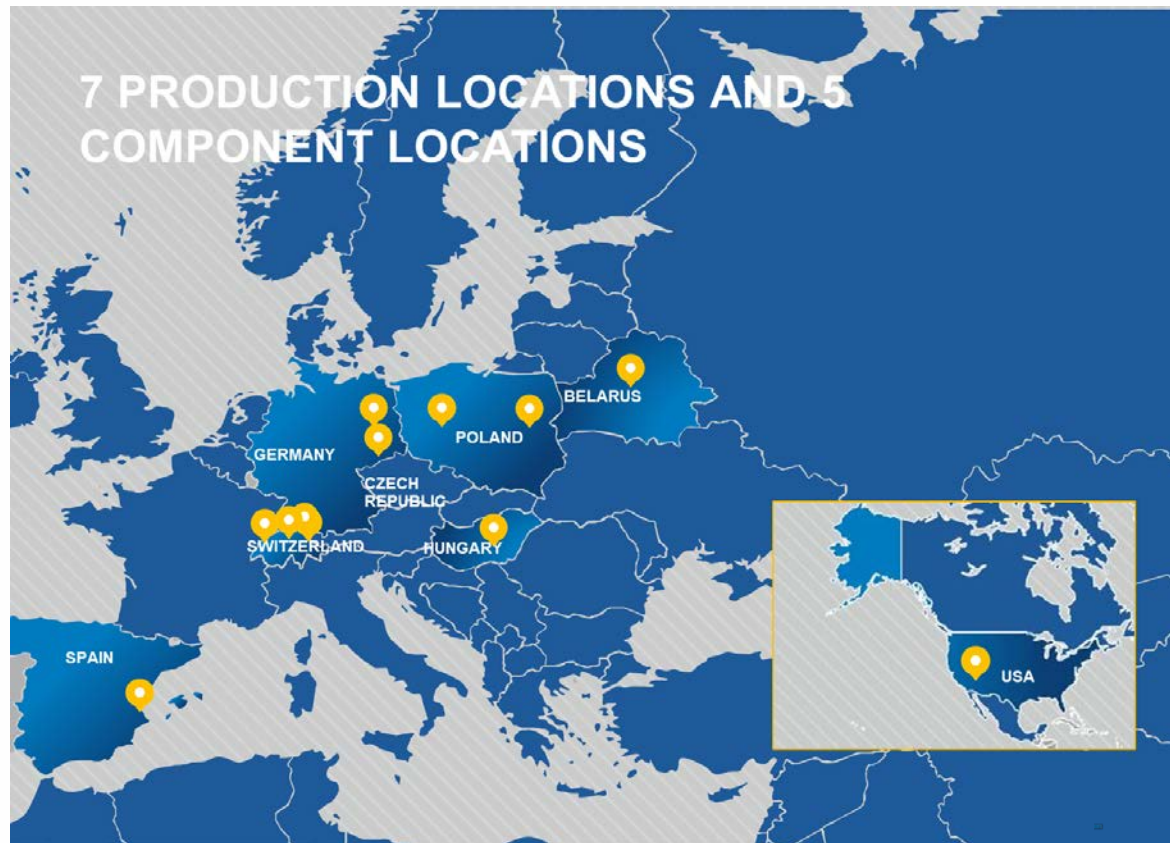

Traceability in Railway - GS1 as standard

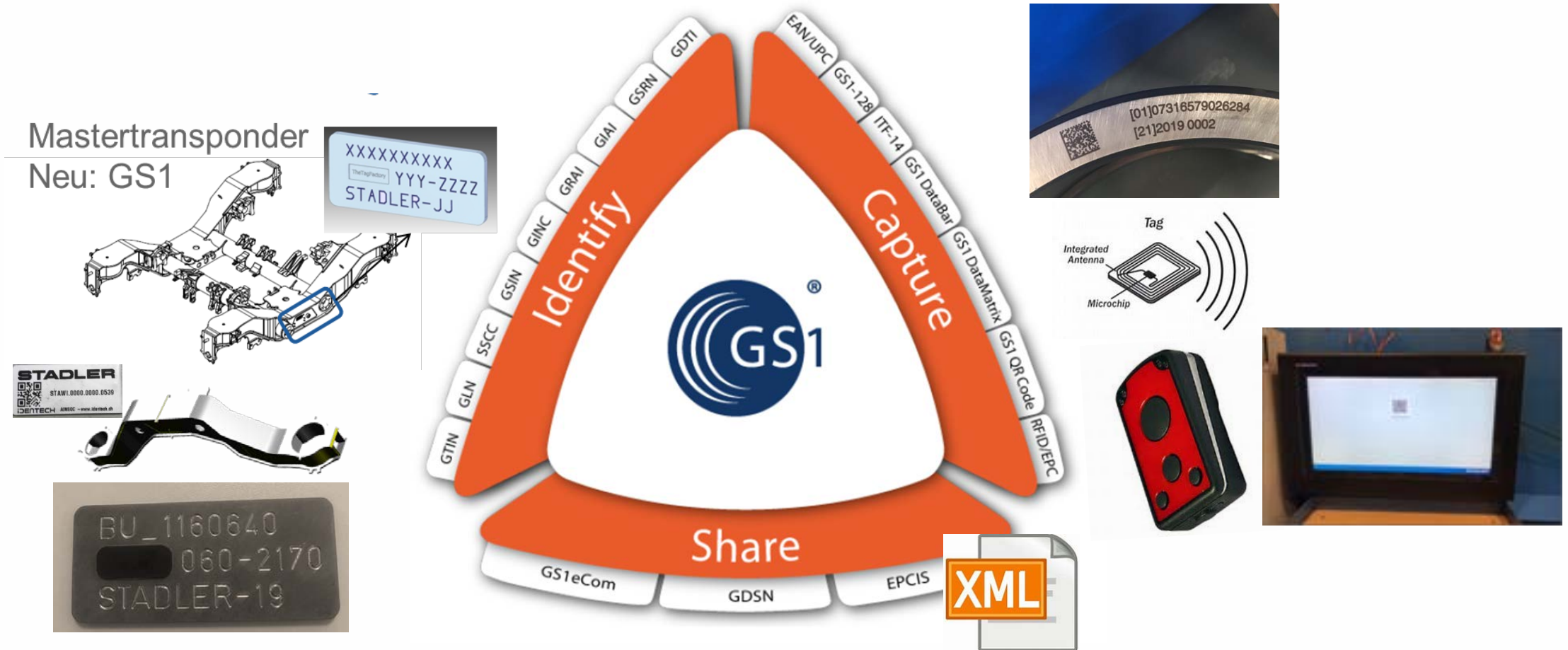

STADLER

RFID
JOURNAL
VIRTUALLY
LIVE!

SEPTEMBER 30 - OCTOBER 1, 2020

Example of a screen – Procedure for the worker

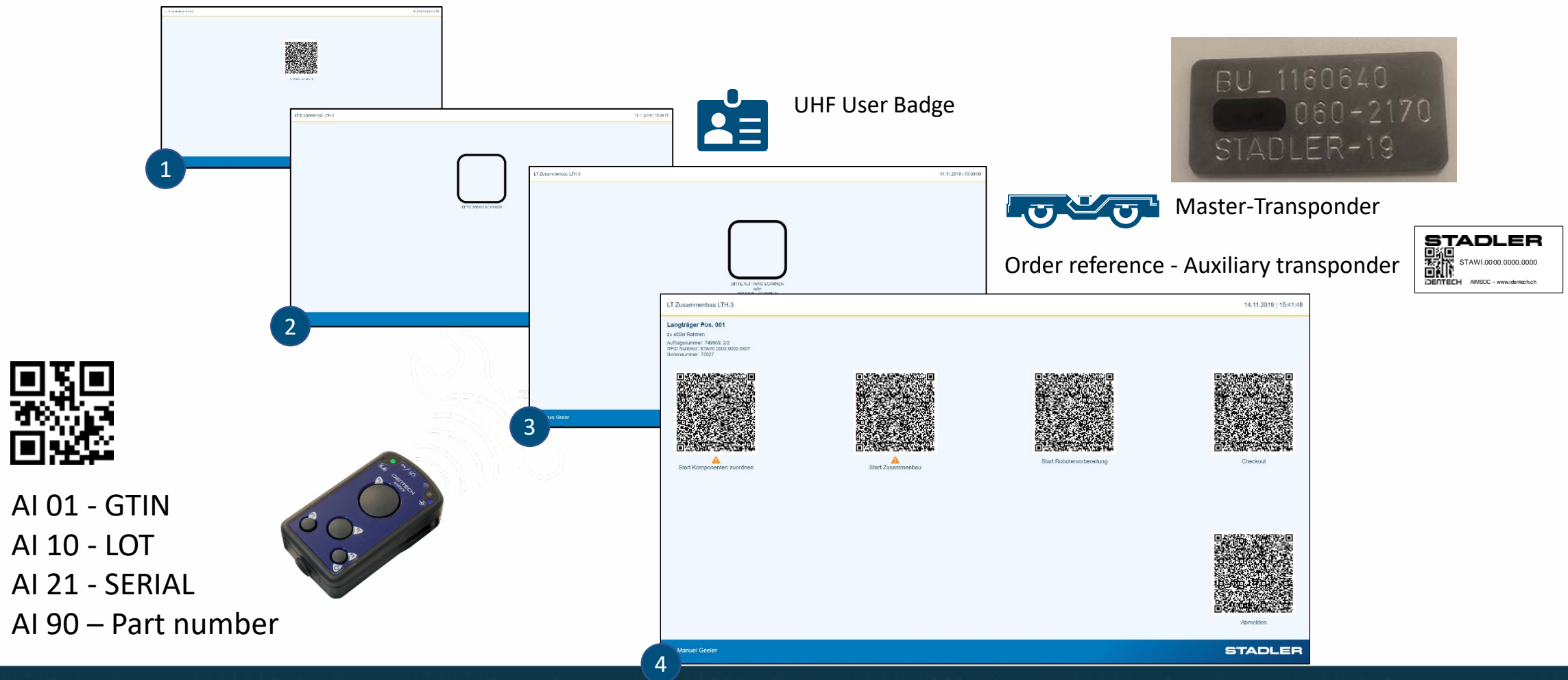

Data in the SQL-Database- Backend

STADLER

AKTUELLER STATUS
AUFTRÄGE
PRODUKTE
VERWALTUNG
BEREICHTE
MEIN KONTO
V.0.7.0

Produkteverwaltung

Produktdetails

Produkttyp: 10100011
Produktbeschreibung 1: Rahmen
Produktbeschreibung 2: Test
SN: 15398
Produkt RFID Referenz: STAWI.0000.0000.5398
Produkt Hierarchie:
15398 Rahmen Test
15407 Chargenpflichtiges Test
15404 Chargenpflichtiges Test
15418 Chargenpflichtiges Test
15423 Chargenpflichtiges Test

Historie

Produktionsschritt	Station	Startdatum	Enddatum	Dauer
Start Komponenten zuordnen	RBH 3	27.08.2018 16:44:38.283	27.08.2018 16:50:19.610	0 Tage(j) 00:05:41.327
Komponente zuordnen	RBH 3	27.08.2018 16:47:40.127		
Komponente zuordnen	RBH 3	27.08.2018 16:48:03.453		
Komponente zuordnen	RBH 3	27.08.2018 16:48:40.483		
Start Heften 2	RBH 3	27.08.2018 16:51:33.860	27.08.2018 16:51:40.827	0 Tage(j) 00:00:06.967
Start Heften 1 + 2	RBH 3	27.08.2018 16:51:43.517	27.08.2018 16:51:48.297	0 Tage(j) 00:00:02.780
Start Komponenten zuordnen	RBH 3	27.08.2018 17:04:53.903	27.08.2018 17:05:42.717	0 Tage(j) 00:00:48.814
Komponente zuordnen	RBH 3	27.08.2018 17:05:32.323		
Checkout	RBH 3	27.08.2018 17:05:54.610		

1 bis 9 von 9 Einträgen

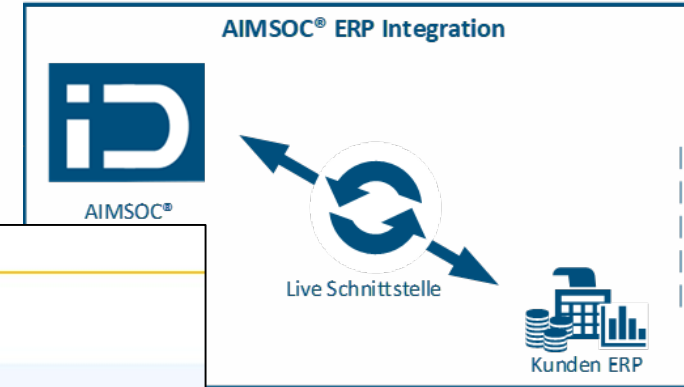

STADLER

RFID
JOURNAL
VIRTUALLY
LIVE!

SEPTEMBER 30 - OCTOBER 1, 2020

RFID as Key for the machines

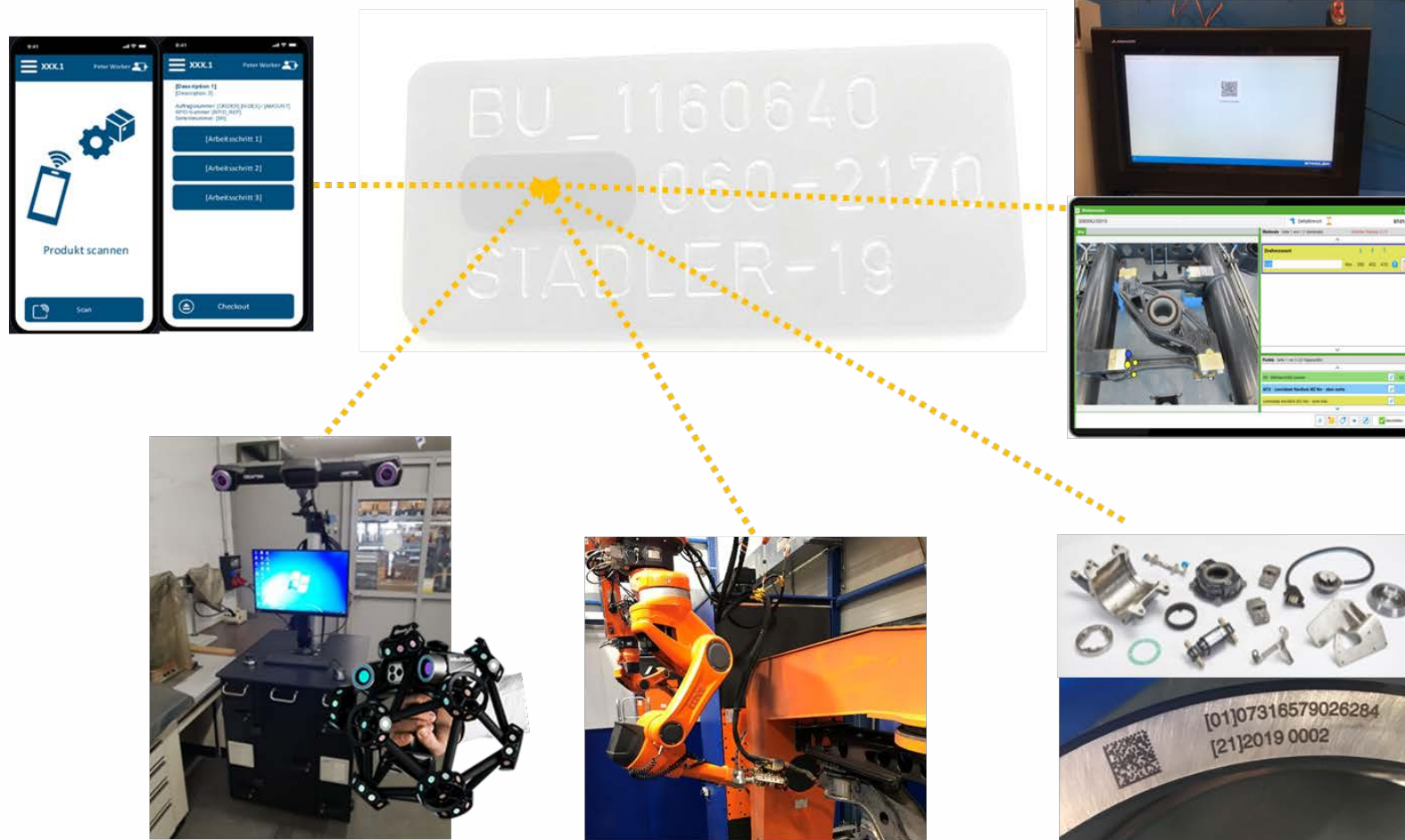

STADLER

RFID
JOURNAL
VIRTUALLY
LIVE!

SEPTEMBER 30 - OCTOBER 1, 2020

Benefits

1. Traceability live as Database – Future: EPCIS
2. Increasing of data quality due to scans instead of making notes
3. Eliminating of 10 manual process steps
(no paper, no manuals, no notes, no component list, no stamping, no checking)
4. Less failures and costs due to digital instructions
5. Controlling the machines – Starting the program and setting up parameters
6. Direct input for ERP-based planning: Relieve the ressources of the ERP live
7. Data collection for Business Intelligence (Lead time, Process-time, OEE)

THANK YOU

RFID
JOURNAL
VIRTUALLY
LIVE!